



PHILLIPS AND ASSOCIATES ARCHITECTS, INC.

ARCHITECTS | PLANNERS | RESEARCH

344 West Chestnut Street Canton, IL 61520 Phone: 309-647-2978 www.paarchitects.com

June 4, 2021

Mr. Scott Petrie, Superintendent
Mercer County School District # 404
1002 SW 6th Street
Aledo, IL 61231

RE: Bid – PA #4041 Mercer County High School Welding Classroom Work

Dear Mr. Petrie,

On Thursday, June 3, 2021, three bids were received for the Mercer Sr. High Welding Classroom Work. The bids received were competitive as shown on the attached bid summary sheet. Drawings were issued to sixteen potential bidders, suppliers and plan rooms.

The low bid is from Crawford Company. We have worked with Crawford Company on other projects and their work has met the specifications in timing and quality.

Illinois statutes require the acceptance of the low bid, unless the bidder is non-responsive or is not a responsible bidder. We have no information that would disqualify the bid and believe Crawford Company to be a responsive and responsible bidder.

It is our opinion that the Board of Education accepts the low base bid submitted by Crawford Company in the amount of \$143,000. Our estimate was \$150,000.

The project included an alternate bid to provide and install automatic arc/current sensing switches at each welding location. The sensors detect an arc or current and immediately turn the filtration fans on. If funds are available, we recommend accepting this alternate. We believe the detectors add safety for students when welding is in progress.

The work is scheduled to start on or after June 28th, 2021. The project substantial completion is on or before October 1, 2021.

If you have any questions or need additional information, please contact me.

Sincerely,
PHILLIPS & ASSOCIATES ARCHITECTS, INC.

Matthew V. Longenecker

MVL/kjb

PRELIMINARY ESTIMATE OF COST NEW WELDING STATIONS

	<u>EXTEND</u>	<u>SUBTOTAL</u>
WELDING STATION IMPROVEMENTS		
MOBILIZATION	\$1,500	
GENERAL WORK		
WALL PATCHING	\$3,000	
MEZZANINE FLOOR PATCHING	\$3,000	
		<u>\$7,500</u>
MECHANICAL		
NEW SMOKE EXTRACTORS (7)	\$65,000	
DEMO EXISTING EXTRACTION UNITS	\$6,800	
MISC	\$7,000	
		<u>\$78,800</u>
ELECTRICAL		
DEMOLITION	\$8,000	
NEW PANEL	\$8,000	
CIRCUITS, CONNECTIONS, RECEPTACLES	\$35,000	
		<u>\$51,000</u>
REMOVAL OF EXISTING HOODS BELOW MEZZANINE	\$0	
NEW WELDING STAND PIPES (13)	\$0	
NEW WELDING SCREENS (13)	\$0	
SUBTOTAL		<u>\$137,300</u>
CONTINGENCY	5%	\$6,865
DISTANCE FACTOR	5%	<u>\$6,865</u>
CONSTRUCTION ESTIMATE OF COST		\$151,030
OTHER ITEMS		
DESIGN AND ENGINEERING	\$15,103	
		<u>\$15,103</u>
<u>OPINION OF ESTIMATE OF COST</u>		\$166,133

Since the architect has no control over the availability of materials or labor or the bid climate, he makes no warranties or guarantees about the accuracy of construction estimates.

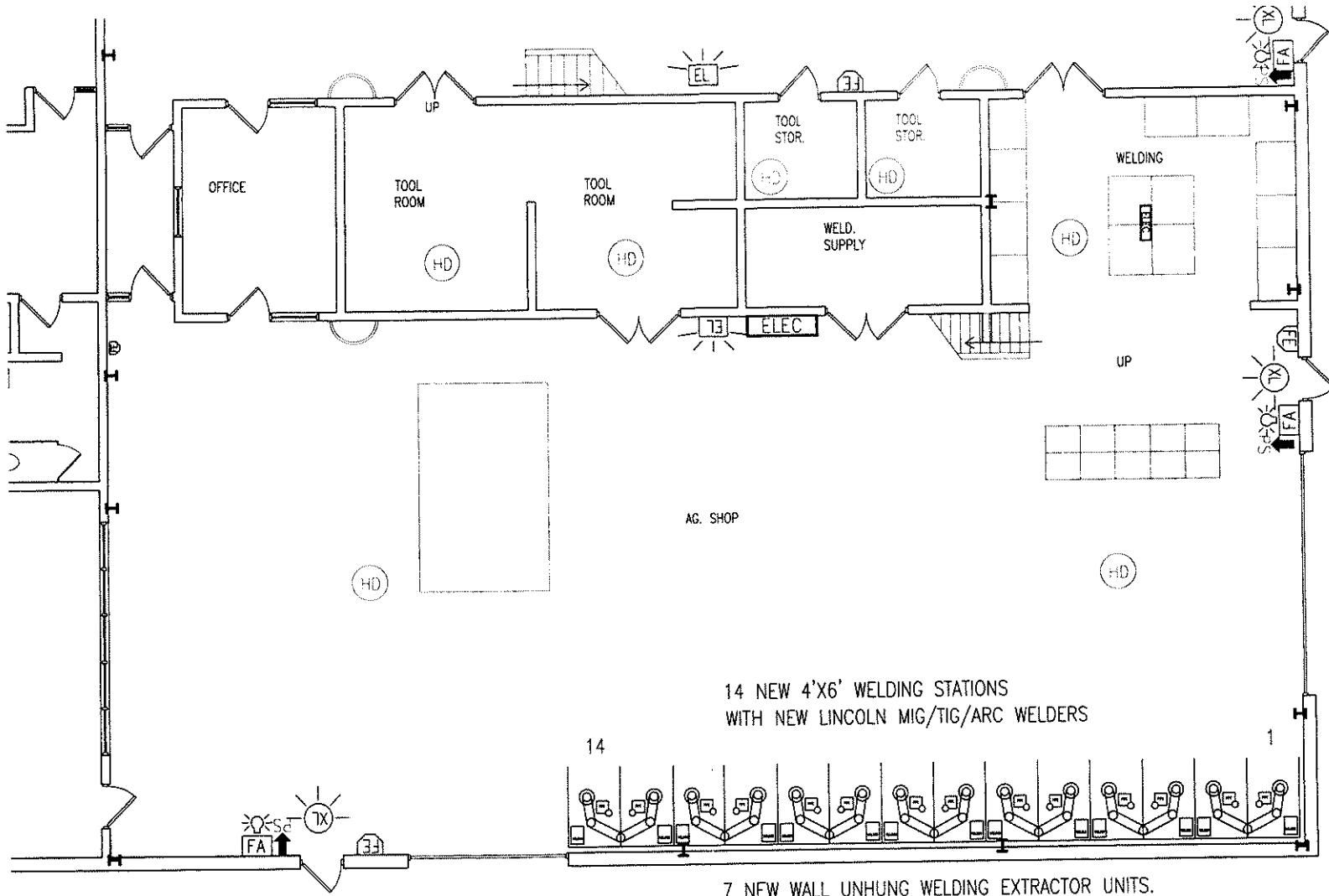

AG SHOP PARITAL FLOOR PLAN

SCALE: 1/8"=1'-0"

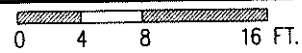

MERCER COUNTY
HS AG SHOP
WELDING BOOTHS
PA #4041
4-27-21



PHILLIPS AND ASSOCIATES ARCHITECTS, INC.

ARCHITECTS | PLANNERS | RESEARCH

344 West Chestnut Street, Canton, IL 61520 Phone: 309-647-2928 www.paaarchitects.com

BID-RECAP

PROJECT NAME: Mercer County Sr. High Welding Classroom Work
PROJECT #: 4041
BID DATE: June 3, 2021
BID TIME: 2:00 P.M. Prevailing Time
ADDRESS: Board of Education Meeting Room
1002 SW 6th St Aledo, IL 61231

	BASE BID	ALT #1 Provide ARC Sensor Switch for each Welding Booth (14)	TOTAL
CRAWFORD CO	\$143,000	\$18,219	\$161,219.00
THE PIPCO COMPANIES, LTD	\$152,500	\$21,800	\$174,300.00
MECHANICAL SERVICE, INC. (MSI)	\$170,148	\$11,324	\$181,472.00